



service bulletin

Panel assembly for Triumph TR7

Smiths Industries Instrument Code IP 6807/ Series

This range of panels is used in the Triumph TR7 sports car variants. The Equipment Schedules will show which panel is fitted to each version.

The IP 6807 series is a significant development in packaged instrumentation in that all the major service items (except the printed circuit) can be withdrawn without access to the rear of the panel being needed.

The panel incorporates :-

- Speedometer - Nemag MK V trip with special connection
- Tachometer - Thick film type
- Battery Condition Indicator - Bimetal Indicator
- Fuel Gauge - Air cored
- Temperature Indicator - Air cored
- Clock - Transistorised CTJ type
- Warning lights

Removing the Front Panel - In car

With the front panel removed the instruments and bulbs can be withdrawn. Proceed as follows:-

Remove the radio speaker grille using a wide bladed screwdriver as a lever. Remove the six pozidrive screws retaining the instrument cowl and swing it rearwards to disengage the side tongue from the fascia. Then lift and remove. Remove the three pozidrive screws and washers at the top of the package which retain the window. Slide the window upwards following the path of its natural arc. Care should be taken to avoid scratching the window. Remove front mask.

Removing the complete Panel from the car

Refer to Triumph instructions

Removing the Instruments (except Clock)

All the instruments except the clock are mounted with lugs formed on the dial and retained by self-tapping screws. (27). If these screws are removed, the instruments may be CAREFULLY

withdrawn by holding the dial between the fingers and pulling gently taking care to avoid damaging the pointer.

The speedometer dial mounting lugs incorporate anti-vibration mounting grommets (15).

Removing the Clock

The clock is mounted on a plate (8) which is retained in the panel by the same type of screws (27) as the other small instruments.

The complete clock assembly should now be manoeuvred out of the panel, drawing the reset stem through the back of the case. Detach the reset stem (37).

If the clock requires replacement this plate must be detached as it is not included in the clock code. It is attached to the clock by two nuts (6) and washers (7).

Removing Warning Light Bulbs

The warning light boxes can be removed by pulling them gently away from their mounting pegs. The capless bulbs (5) are then simply pulled out of their holders using two fingers.

Alternatively, if rear access to the panel is available, the bulb holders can be rotated half a turn anti-clockwise, withdrawn and the bulb separated.

Removing Illumination Bulbs

Illumination bulbs (11) may be removed either from the back or front of the panel.

If they are removed from the FRONT, the adjacent instruments must be withdrawn and the green filter domes (14) prised away from the case. GREAT CARE is needed in this operation to avoid breaking the case lugs. The bulbs are then withdrawn as for the warning lights.

If the bulbs are withdrawn from the REAR, the holders should be rotated, anti-clockwise, half a turn and withdrawn.



SMITHS INDUSTRIES LIMITED

MOTOR ACCESSORY SALES & SERVICE DIVISION

Ref. No. S6230

OXGATE LANE LONDON NW2 - Telephone : 01-452 3333

Removing the Printed Circuit

The printed circuit can only be detached with the panel removed from the car.

Because of the difficulties which can be experienced in removing the contact clips (34) with the instruments in place, it is recommended that all instruments are removed before the circuit is detached.

The printed circuit is retained by the contact clips, (34) bulb holders (39,45) and fasteners (38, 46).

Reassembly

Reassembly is the reverse of dismantling but great care is needed to avoid damage to:-

- The instrument pointers
- Illumination bulb filter retaining lugs
- Printed circuit

TESTING DETAILS

Speedometer SN 5365/00S and SN 5365/01S

This is a MK V trip instrument operating at the revolutions listed below, and can be tested through the normal channels

- SN 5365/00S 1000 RPM MPH
- SN 5365/01S 620 RPK KPH

Multi-plug Connectors as viewed from rear of panel:

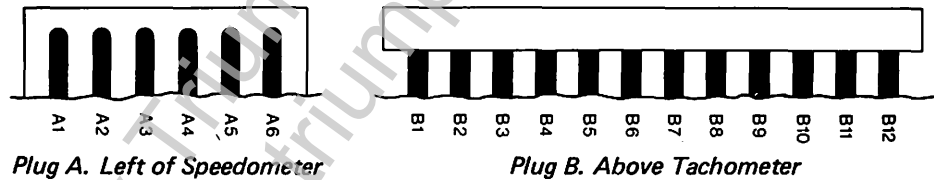

Circuit Diagram :

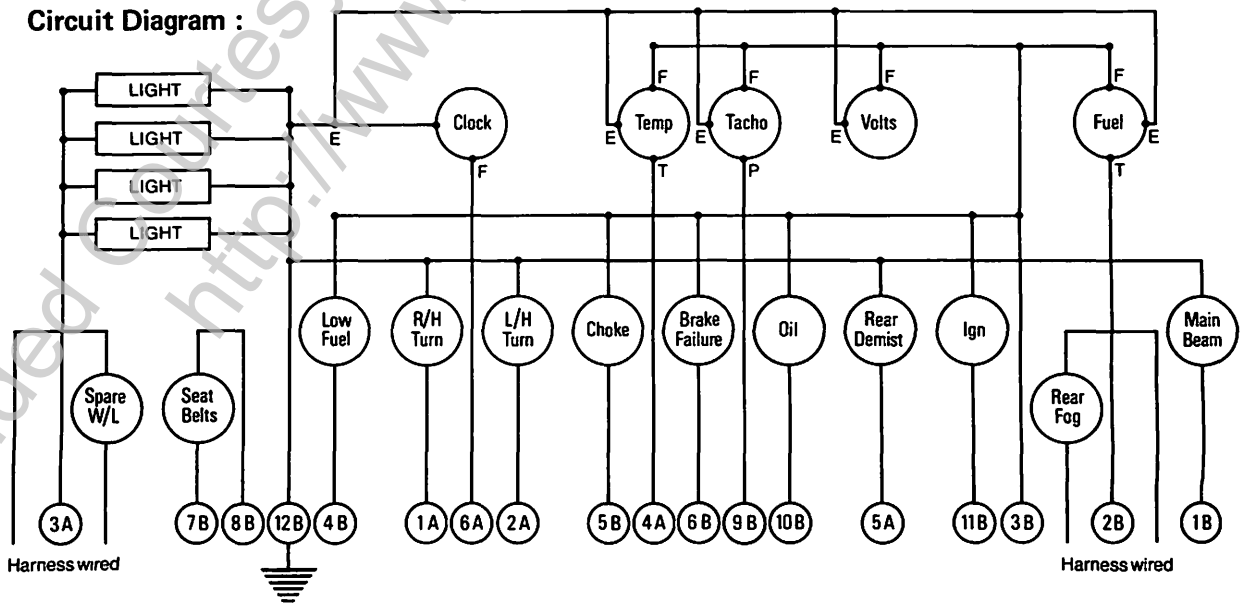

Tachometer RVC 6419/00F

This is the latest thick film integrated circuit voltage triggered type instrument and can be tested through the normal channels.

Fuel and Temperature Indicators

These are of the latest air cored type movement and can be tested using the SR/D409 instrument tester

Battery Condition Indicator

This is of the bi-metal type and can be tested against a known good voltmeter.

Clock

This has a transistorised movement and runs direct from the cars electrical system. It can be tested by connection to a 12 volt supply, blade terminal positive, stud negative.

Triumph TR7 (Bullet) Panel IP 6807/00S

Item	Description	Code	Quantity
1	Screw No. 6 x 1/2" long type A.B. pozidrive	31-216-018-19	3
	OR Screw No. 6 x 1/2" long pan head type B	30-216-118-11	3
2	Washer	31-512-301-01	3
3	Special nut No. 6 AB thread	30-272-156-34	3
4	Back case	31-713-143-01	1
5	Bulb capless 1.2w 12 volt	40-621-109-86	11
6	Nut M4 BS 3692-8	20-271-1050-11	2
7	Spring Washer	20-181-1008-11	2
8	Mounting plate clock	31-634-621-01	1
9	Clock	CTJ 3702/00	1
* 10	Speedometer	SN 5365/00S	1
11	Bulb Capless 2.2w 12 volt	40-621-109-74	4
12	Temperature Indicator	ACT 8102/00	1
13	Foam strip	1815-309	2 x 176 mm
14	Moulded lamp cover	31-712-107-00	4
15	Grommet	30-781-611	3
16	Flange spacer	31-334-703-03	3
17	Screw No. 6 x 1/2" long type AB	30-216-1005-19	3
18	Front mask	31-717-756-01	1
19	Window	31-786-523-00	1
20	Foam strip	1815-310	1 x 387 mm
22	Foam pad	31-755-714-71	2
23	Warning light box	41-718-135-00	1
24	Lampholder	40-745-883	1
25	Tachometer	RVC 6419/00F	1
26	Fuel Indicator	ACF 8103/00	1
27	Screw No. 4 x 3/8" long type AB	30-216-1004-19	11
28	Battery Condition Indicator	BV 8115/00	1
29	Warning light tube (beam)	41-718-186-01	1
30	Rubber tube	1817-135	4 x 9 mm
31	Warning light tube (rear demist)	41-718-186-00	1
32	Captive nut No. 8 type AB	30-272-401-34	2
33	Printed circuit	31-865-189-50	1
34	Contact clips	31-385-512	13
35	Screw No. 4 x 1/4" long type A.B.	30-216-107-19	13
36	Remote control (Trip)	41-741-183-00	1
37	Remote control (Clock)	41-741-182-00	1
38	Button fasteners	30-736-331-01	3
39	Lampholder	40-745-889	10
40	Flexible drive mounting	31-715-141-00	1
41	Screw No. 6 x 5/8" long type B	30-216-119-19	2
42	Flange spacer	31-716-608-00	2
43	Grommet	30-781-613	2
44	Mounting pad	31-716-418-00	1
45	Lampholder	40-745-860	4
46	Button fastener	30-736-337-01	1

* Note on KPH versions item 10 is SN 5365/01S

Instrument and Panel Assembly

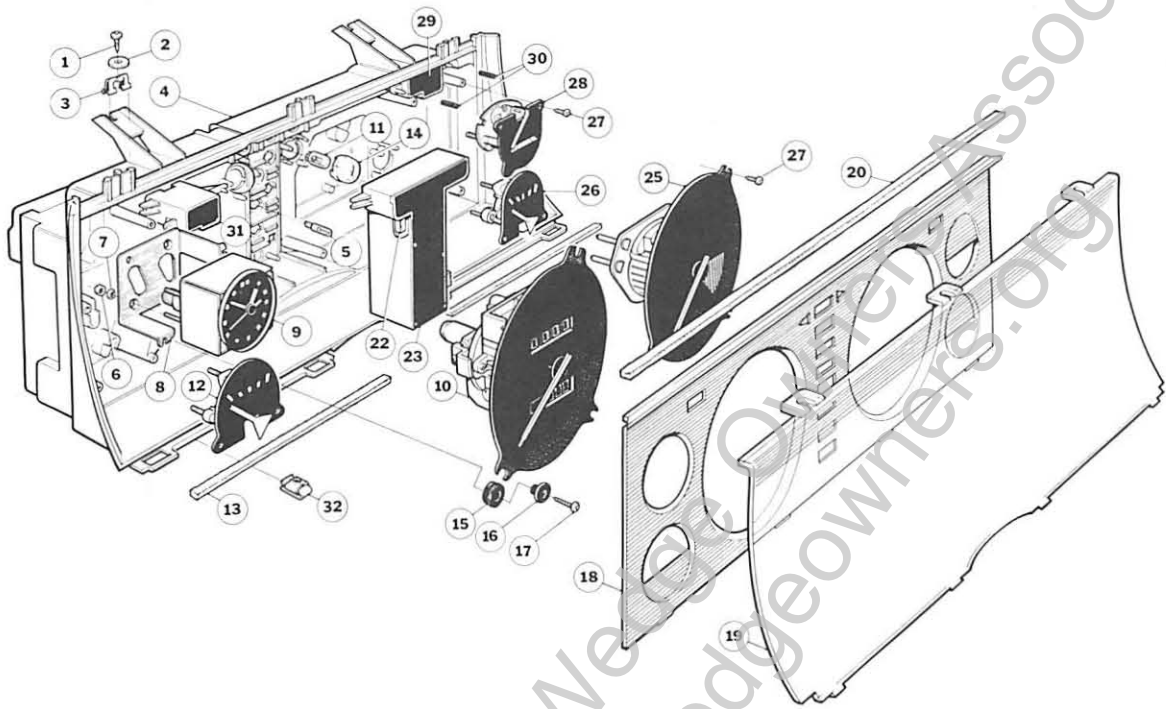

Printed Circuit and Rear of panel

